

ADDRESS
97 Dundas Street West, Ormiston, QLD, 4160

REAL PROPERTY DESCRIPTION

Lot 1-5 on RP109238
Lot 1 on RP122772
Lot 1 on RP127130
Lot 100-102 on SP306734
Lot 1 & 2 on RP110831
Lot 3 on RP49638

- EXISTING BUILDINGS, STRUCTURES AND EMBELLISHMENTS
- NEW DEVELOPMENT WORKS
- DXX

NEW GENERAL SCHOOL DEVELOPMENT
- JXX

NEW JUNIOR SCHOOL DEVELOPMENT
- SXX

NEW SECONDARY SCHOOL DEVELOPMENT
- EXX

EXISTING BUILDINGS, STRUCTURES AND EMBELLISHMENTS

Y	06-06-2025	ISSUE FOR INFORMATION	MS
X	24-03-2025	ISSUE FOR INFORMATION	MS
W	24-02-2025	ISSUE FOR INFORMATION	MS
V	23-04-2024	ISSUE FOR INFORMATION	AS
U	13-03-2024	ISSUE FOR INFORMATION	MS
T	12-03-2024	ISSUE FOR INFORMATION	MS
S	08-03-2024	ISSUE FOR INFORMATION	MS
R	14-10-2022	REVISED PLAN	MS
Q	07-10-2022	REVISED PLAN	MS
P	28-09-2022	REVISED PLAN	MS
O	23-09-2022	REVISED PLAN	MS
N	21-03-2022	REVISED PLAN	MS
M	01-03-2022	REVISED PLAN	MS
L	03-12-2021	REVISED PLAN	CG
K	26-11-2021	JUNIOR SCHOOL & ELC REVISED	CG
J	16-11-2021	DELANCY ST PARKING REVISED	CG
I	10-11-2021	MASTER PLAN REVISED	CG
H	02-11-2021	MASTER PLAN REVISED	CG
#	DATE	REVISION	BY



ROHRIG
THIS DOCUMENT AND ITS CONTENTS REMAIN THE PROPERTY OF ROHRIG. ROHRIG RETAINS ALL INTELLECTUAL PROPERTY RIGHTS IN THIS DOCUMENT AND ITS CONTENTS. NO PART OF THIS DOCUMENT OR ITS CONTENT MAY BE REPRODUCED, COPIED, ALTERED OR MODIFIED WITHOUT THE EXPRESS WRITTEN CONSENT OF ROHRIG.
ABN 67 093 753 970
QBSA LIC NO 740842
© 2021 ROHRIG

248 ABBOTSFORD ROAD, BOWEN HILLS QLD 4006
PO BOX 86 ALBION DC QLD 4010 AUSTRALIA
PHONE: (07) 3257 4411 FAX: (07) 3257 2211
EMAIL: qld@rohrig.com.au



ALL DIMENSIONS TO BE CHECKED ON SITE. WRITTEN DIMENSIONS ONLY TO BE USED. REFER TO ALL DETAIL DRAWINGS. STRUCTURAL, MECHANICAL & SERVICES DRAWINGS BEFORE COMMENCING WORK. REFER ANY DISCREPANCIES TO THE ARCHITECT. DO NOT COPY OR ALTER THE DESIGN SHOWN HEREIN IS RETAINED BY ROHRIG. WRITTEN AUTHORITY IS REQUIRED FOR ANY REPRODUCTION.

CLIENT
ORMISTON COLLEGE

PROJECT
MASTERPLAN DEVELOPMENT

JOB No.
QC2120

TITLE
PROPOSED MASTER PLAN

DRAWN	APPROVED	15	0	15	30	45	60	75
MS	SS	SCALE 1:1500 @1 A1						

DRAWING No. **A-01-0001** ISSUE **Y**

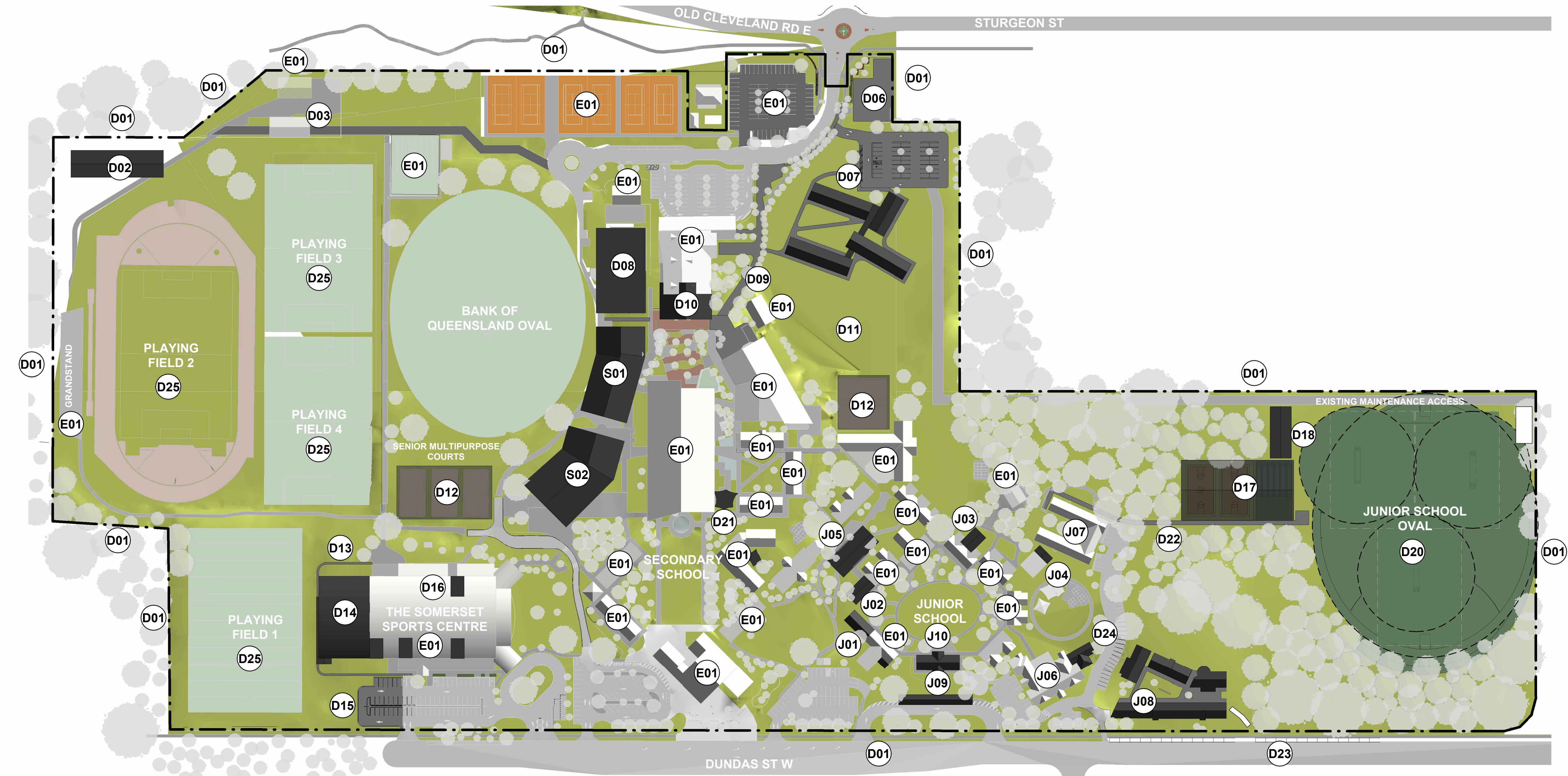

- D01NEW FULL PERIMETER BOUNDARY SECURITY FENCE WITH AUTOMATIC VEHICULAR SLIDING GATES, PEDESTRIAN ACCESS GATES AND KOALA CROSSING AS REQUIRED
- D02NEW MULTI USE BUILDING- EDUCATIONAL TEACHING SPACES AND STORAGE (2 STOREY)
- D03NEW MULTI USE BUILDING- UTILITIES, MAINTENANCE AND ARCHIVE (2 STOREY)
- D06NEW GROUNDS/GREEN KEEPERS' SHEDS
- D07NEW BOARDING FACILITY (3 STOREY) AND ASSOCIATED CARPAKING/DROP OFF ZONE
- D08NEW AQUATIC CENTRE (50m POOL) & MULTI-USE EDUCATIONAL BUILDING (2 STOREY)
- D09NEW STURGEON STREET CONNECTION PATH AND LANDSCAPE
- D10LINGO LIN PERFORMING ARTS THEATRE EXTENSION
- D11NEW OUTDOOR PLAY AREA
- D12COVERED AREA TO EXISTING MULTIPURPOSE COURTS
- D13NEW CONCRETE CONNECTION PATHWAY
- D14SPORTS COURT EXTENSION AND NEW GRANDSTAND (2 STOREY)
- D15CARPARK EXTENSION TO DUNDAS ST W CARPARK
- D16SOMERSET SPORTS CENTRE COVERED ENTRIES
- D17NEW INDOOR MULTI PURPOSE COURTS WITH ENCLOSED CRICKET PITCH AND NETS
- D18NEW STORAGE SHED INC NEW CHANGE ROOMS / AMENITIES (1 STOREY)
- D20NEW JUNIOR SCHOOL SPORTS FIELDS WITH EXTERNAL SPORTS LIGHTING
- D21NEW EXTERNAL SHADED SEATING
- D22NEW CONCRETE COVERED CONNECTION PATHWAY FOR BRANCH FALL PROTECTION
- D23NEW COUNCIL STREET PARALLEL PARKING
- D24EXTENSION TO EXISTING CARPARK
- D25NEW FIELD LIGHTING TO EXISTING FIELD
- J01BUILDING EXTENSION- YEAR 4 (1 STOREY)
- J02BUILDING EXTENSION- YEAR 5 (1 STOREY)

- J03NEW CHANGEROOM/AMENITIES (1 STOREY)
- J04EXTENSION TO AMENITIES (1 STOREY)
- J05EXTENSION TO CHANGEROOM/AMENITIES (1 STOREY)
- J06REPURPOSE AND EXTEND EXISTING PREP FOR GRADE 1 GLAS (1 STOREY)
- J07REPURPOSE EXISTING ELC FOR PREP PRECINCT (1 STOREY)
- J08NEW EARLY LEARNING CENTRE AND CONNECTED CARPARK (2 STOREYS)
- J09NEW COVERED JUNIOR SCHOOL DROP OFF ZONE
- J10NEW ADMINISTRATION BUILDING (2 STOREY)
- S01NEW BUSINESS STUDIES AND ARTS PRECINCT (3 STOREY)
- S02NEW MULTI-USE BUILDING- EDUCATIONAL TEACHING SPACES WITH AMENITIES (2 STOREY)

E01EXISTING BUILDINGS, STRUCTURES AND EMBELLISHMENTS

EXISTING CARPARKING

- ADMINISTRATION CARPARKING48
- BUS STOP1
- EXISTING STREET PARKING9
- JUNIOR SCHOOL CARPARKING51
- LINGO LIN PERFORMING ARTS CENTRE CARPARKING73
- PREP SCHOOL CARPARKING41
- SPORTS CENTRE CARPARKING43
- STURGEON STREET CARPARKING72
- 338

NEW CARPARKING

- EARLY LEARNING CARPARKING (D24)18
- NEW CARPARKING (D07)39
- NEW COUNCIL STREET PARALLEL PARKING (D23)24
- SOMERSET SPORTS CENTRE ADDITIONAL CARPARKING (D15)26
- 107